



中国认可
国际互认
检测
TESTING
CNAS L6478



TEST REPORT

Report No. : WTF22F11226914C

Applicant : Mid Ocean Brands B.V.

Address : 7/F., Kings Tower, 111 King Lam Street, Cheung Sha Wan,
Kowloon, Hong Kong

Manufacturer : 111652

Sample Name : Bowling sport bag

Sample Model : MO7868

Test Requested : 1) Determination of Lead content in the submitted sample in accordance with REACH regulation Annex XVII Entries 63 (EC) No. 1907/2006 and the amendment No. 836/2012 and (EU) 2015/628
2) Determination of Cadmium content in the submitted sample in accordance with REACH regulation Annex XVII Entries 23 (EC) No. 1907/2006 and the amendment No. 552/2009, No. 494/2011, No. 835/2012 and (EU) 2016/217
3) Determination of specified Phthalates content according to Annex XVII Items 51 & 52 of the REACH Regulation (EC) No. 1907/2006 & Amendment No. 552/2009 & No. 2018/2005

Test Conclusion : Refer to next page (s)

Date of Receipt sample : 2022-11-11

Testing period : 2022-11-11 to 2022-11-17

Date of Issue : 2022-11-17

Test Result : Refer to next page (s)

Note : As specified by client, only test the designated sample.

Prepared By:

Waltek Testing Group (Foshan) Co., Ltd.

Address: No.13-19, 2/F., 2nd Building, Sunlink International Machinery City,
Chencun, Shunde District, Foshan, Guangdong, China
Tel:+86-757-23811398 Fax:+86-757-23811381 E-mail:info@waltek.com.cn

Signed for and on behalf of
Waltek Testing Group (Foshan) Co., Ltd.

Swing.Liang

Waltek Testing Group (Foshan) Co., Ltd.
<http://www.waltek.com.cn>



Report No.: WTF22F11226914C

Sample photo:



WALTEK



Report No.: WTF22F11226914C

Test Results:

1) Lead (Pb)

Test Method: With reference to IEC 62321-5:2013, the analysis was performed by ICP-OES.

Test Item	LOQ (mg/kg)	Results (mg/kg)		Limit (mg/kg)
		No.1+No.2+No.3	No.4+No.10	
Lead(Pb)	2	ND*	ND*	500
Conclusion	--	Pass	Pass	--

Test Item	LOQ (mg/kg)	Results (mg/kg)			Limit (mg/kg)
		No.5+No.11	No.6	No.7	
Lead(Pb)	2	ND*	ND	ND	500
Conclusion	--	Pass	Pass	Pass	--

Test Item	LOQ (mg/kg)	Results (mg/kg)		Limit (mg/kg)
		No.8+No.12	No.9	
Lead(Pb)	2	ND*	ND	500
Conclusion	--	Pass	Pass	--

Note:

- (1) mg/kg = milligram per kilogram
- (2) ND = Not Detected (lower than LOQ)
- (3) LOQ = Limit of quantitation
- (4) Limit of Lead was quoted from REACH regulation Annex XVII Item 63 (EC) No. 1907/2006 and the amendment No. 836/2012 and (EU) 2015/628.
- (5) "*" = Results are calculated by the minimum weight of mixed components.



Report No.: WTF22F11226914C

2) Cadmium (Cd)

Test Method: With reference to IEC 62321-5:2013, the analysis was performed by ICP-OES.

Test Item	LOQ (mg/kg)	Results (mg/kg)	
		No.1+No.2+No.3	No.4+No.10
Cadmium(Cd)	2	ND*	ND*
Conclusion	--	Pass	Pass

Test Item	LOQ (mg/kg)	Results (mg/kg)		
		No.5+No.11	No.8	No.9
Cadmium(Cd)	2	ND*	ND	ND
Conclusion	--	Pass	Pass	Pass

Note:

- (1) mg/kg = milligram per kilogram
- (2) ND = Not Detected (lower than LOQ)
- (3) LOQ = Limit of quantitation
- (4) Limit of Cadmium according to REACH regulation Annex XVII Item 23 (EC) No. 1907/2006 and the amendment No. 552/2009, No. 494/2011 and No. 835/2012 and (EU) 2016/217.

Category	Limit (mg/kg)
Wet paint	100
Surface coating	1000
Plastic	100
Metal parts of jewellery and hair accessories	100

- (5) “**” = Results are calculated by the minimum weight of mixed components.



Report No.: WTF22F11226914C

3) Phthalates

Test Method: With reference to EN14372:2004, by Gas Chromatographic-Mass Spectrometric (GC-MS) analysis.

Test Items	LOQ (%)	Results (%)	Limit (%)
		No.1+No.2+No.3	
Benzyl butyl phthalate (BBP)	0.005	ND*	sum of four phthalates < 0.1
Di (2-ethyl hexyl)- phthalate (DEHP)	0.005	ND*	
Dibutyl phthalate (DBP)	0.005	ND*	
Diisobutyl phthalate (DIBP)	0.005	ND*	
Diisodecyl phthalate (DIDP)	0.01	ND*	sum of three phthalates < 0.1
Diisononyl phthalate (DINP)	0.01	ND*	
Di-n-octyl phthalate (DNOP)	0.005	ND*	
Conclusion	--	Pass	--

Note:

DBP= Dibutyl phthalate

BBP= Benzyl butyl phthalate

DEHP= Bis-(2-ethylhexyl)- phthalate

DINP= Di-isononyl phthalate

DNOP= Di-n-octyl phthalate

DIDP= Di-isodecyl phthalate

DIBP= Diisobutyl phthalate

(1) % = percentage by weight

(2) ND = Not Detected or lower than limit of quantitation

(3) LOQ = Limit of quantitation

(4) "<" = less than

(5) The above limit was quoted according to Annex XVII Items 51 & 52 of the REACH Regulation (EC) No.

1907/2006 & Amendment No. 552/2009 & No. 2018/2005 (formerly known as Directive 2005/84/EC) for phthalate content in toys and child care articles.

(6) "*" = Results are calculated by the minimum weight of mixed components.



Report No.: WTF22F11226914C

Description for Specimen:

Specimen No.	Specimen Description
1	White synthetic leather
2	Blue synthetic leather
3	Black synthetic leather
4	Black plastic zipper tooth
5	Black zipper fabric
6	Silvery metal zipper head
7	Silvery metal buckle
8	Black fabric rim
9	Black lining
10	Blue plastic zipper tooth
11	Blue zipper fabric
12	White fabric rim

Photograph of parts tested:

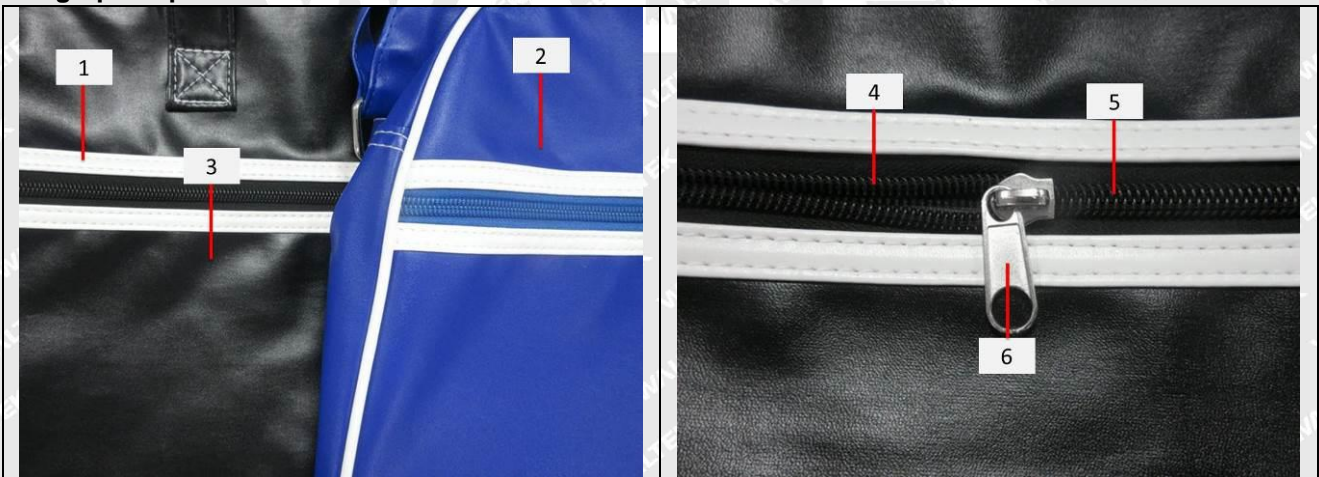



Report No.: WTF22F11226914C

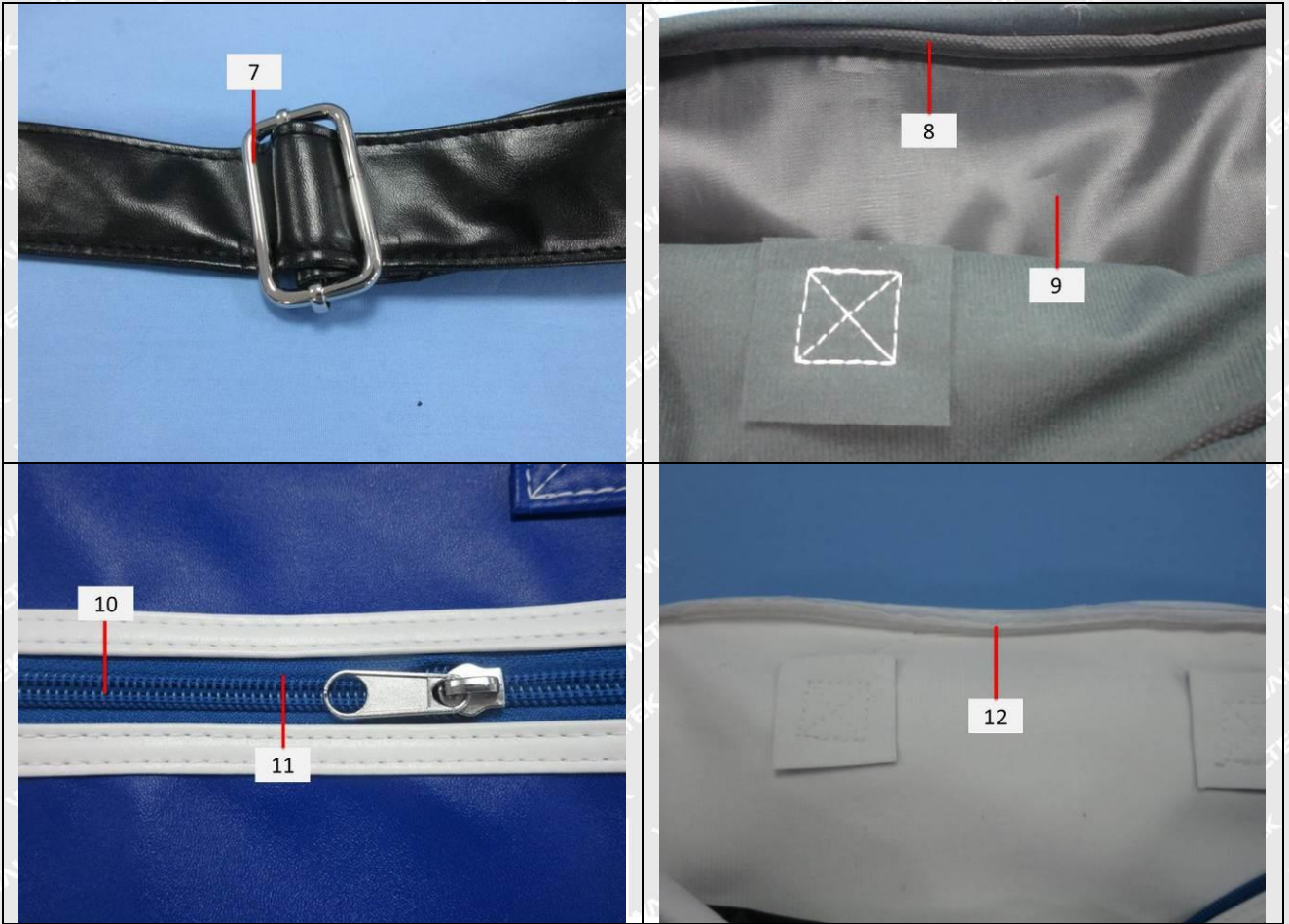



Report No.: WTF22F11226914C

Remarks:

1. The results shown in this test report refer only to the sample(s) tested;
2. This test report cannot be reproduced, except in full, without prior written permission of the company;
3. The report would be invalid without specific stamp of test institute and the signatures of compiler and approver;
4. The Applicant name and Address, the sample(s) and sample information was/were provided by the applicant who should be responsible for the authenticity which Waltek hasn't verified;
5. If the report is not stamped with the accreditation recognized seal, it will only be used for scientific research, education, and internal quality control activities, and is not used for the purpose of issuing supporting data to the society.
6. The sample material information (Model No. information) is provided by client, not verified by test laboratory. The samples of reference Model No. are not tested. Test laboratory not responsible for the accuracy, appropriateness, completeness and authenticity of the information provided by client.

===== End of Report =====

WALTEK